

## **SnowEx DSM-175 Drop Side Mount**

The DSM-175 is redesigned for use with the SnowEx SP-1875 only. The hitch is multi adjustable and designed for the use with drop sided commercial vehicles fitted with a 50mm towing ball. The DSM-175 should not be used with 'Flare side' pick-ups or vehicles that are considered too fragile or easily damaged by the use of the mount. The drop side of the vehicle intended for use must be made from steel or a strong alloy design.

No claim will be upheld by the manufacturer for damage to vehicles or paint finish how so ever caused relating to part fitment or unsuitable vehicle choice or pairing in relation to use of the DSM-175.

Road speed must not exceed 15mph when carrying spreading material in the spreader hopper. Care should be taken when spreading or when travelling over speed bumps, curbs or other traffic calming devices. Particularly when spreading material is being carried in the spreader hopper, do not exceed 2 mph when crossing such devices.

Weight on the DSM-175 should not exceed 335kgs.

Before operating or travelling with a DSM-175 mounted on your vehicle, ensure that it is correctly adjusted to suit your vehicle and that all bolts and straps are tight. Ensure that the vehicle lights and number plate are not obscured, supplementary lights and number plate may be required.

## DSM 175

### PART NO's

### QTY

1.	DSM175/01	Top Hangers	2
2.	DSM175/02	Up Rights	1
3.	DSM175/03	Main Frame	1
4.	DSM175/04	Hitch Leg	1
5.	DSM175/05	Pair of Ratchet Straps	1

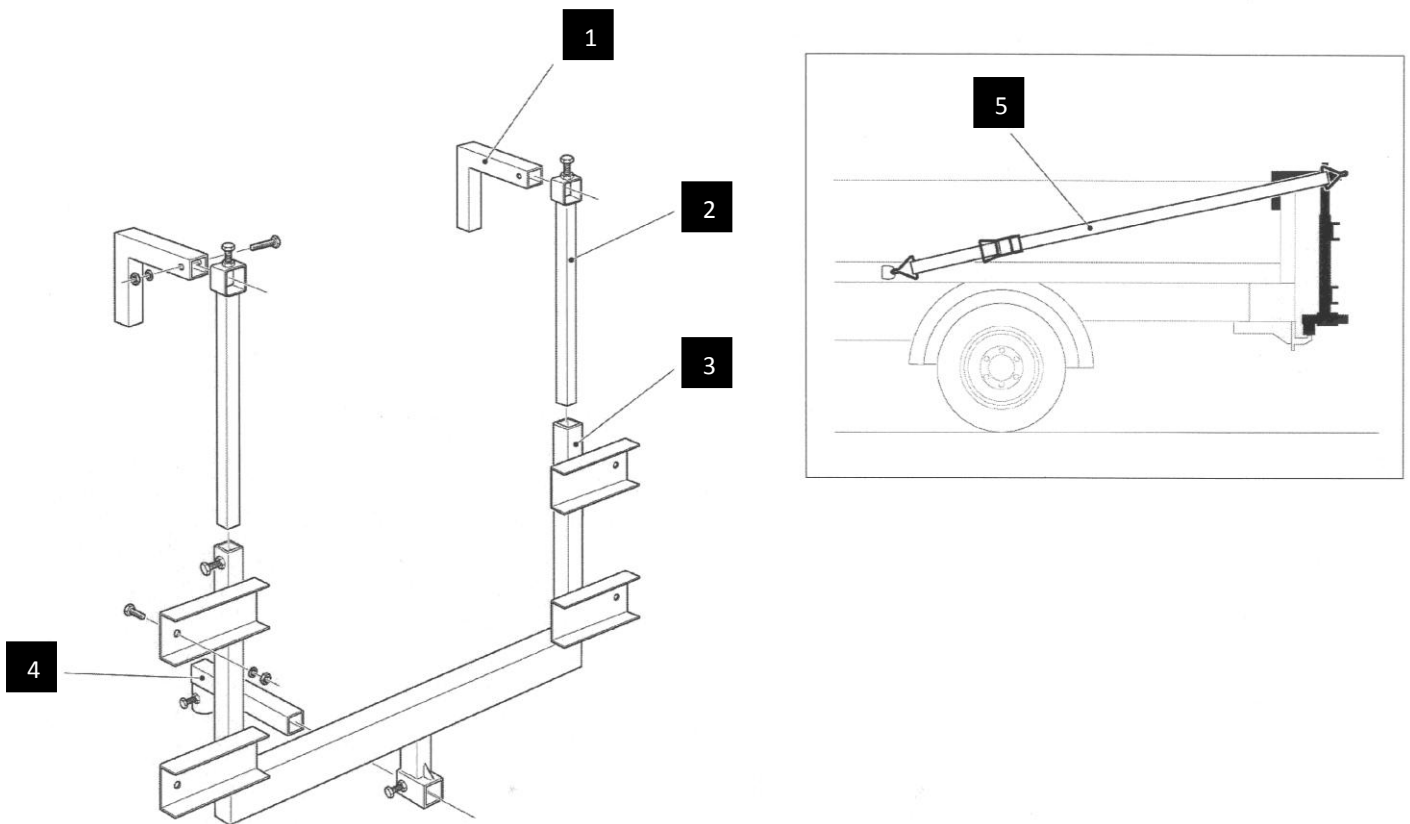

Insert item 3 into bottom socket leave clamp bolt loose.

Lift frame assembly up (3) and hook items 1 over the vehicle tail gate and place item 4 over vehicle ball hitch. Push frame assembly hard against vehicle tail gate and take up any gap between the tailboard in adjusting item 1 to remove any free play.

Tighten all pinch bolts 3 on item 2, 1 and item 4 (over ball hitch)

Take the 2 ratchet straps (item 5) provided and hook to the rear side of the spreader, run both straps forward to a point on the vehicle. Medium tension both straps.